

INSTRUCTIONS

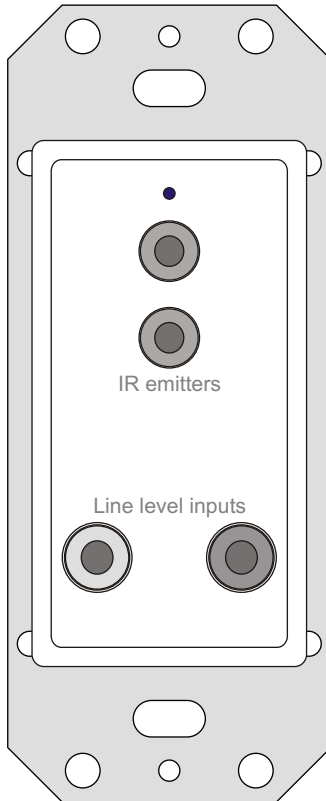

A0301 **Universal Input Module** **For CAT5 Audio Systems**

 CHANNEL VISION™

©2008 CHANNEL VISION TECHNOLOGY

The **A0301** is a universal input module for Channel Vision's CAT5 Audio Systems that can accept audio from any standard L/R line-level audio source. The attractive decorator style faceplate allows the unit to blend in with modern light switches and outlets. It can be used to provide local source input in any room and/or as the main system input device. The A0301 is a great way to enable simple connection of local sources such as TV's, MP3 players, and computer sources into the zone.

Features:

- Compatible with Channel Vision's CAT5 Audio Systems
- Senses audio to automatically override the main audio source
- Provides 2 IR emitter outputs
- Uses CAT5 cabling

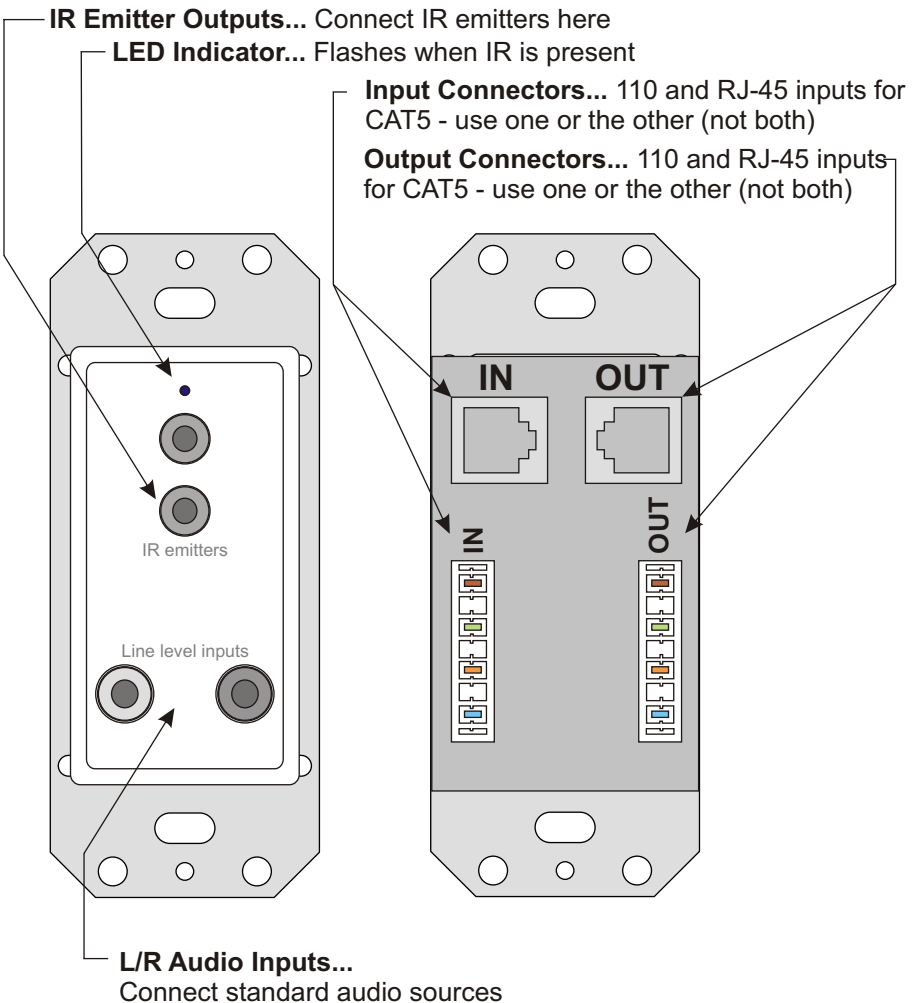

Required System Components

The A0301 is not a standalone device. It must be installed as part of an audio system which requires the following components:

CAT5 Audio Hub or CAT5 Audio Matrix:

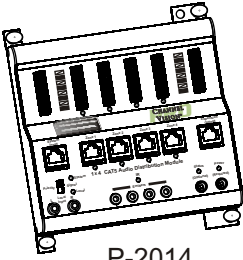

P-2014
(power supply included)

OR

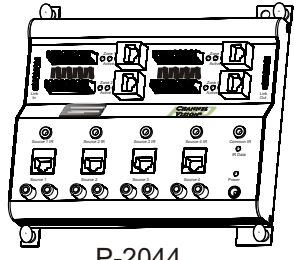

P-2044
(power supply included)

Volume Control Keypad:

A0125

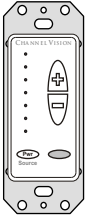

In-Room Amplifier:

A0240

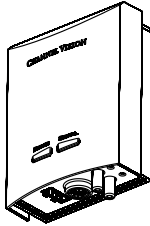

Wiring Interface:

A0302

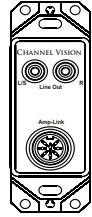

Speakers:

In-ceiling, In-wall and free-standing 8 ohm speakers are acceptable.

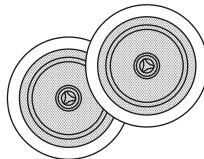
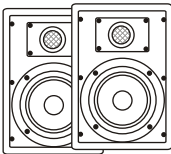

System Wiring Diagram

Using the A0301 as a local source input module

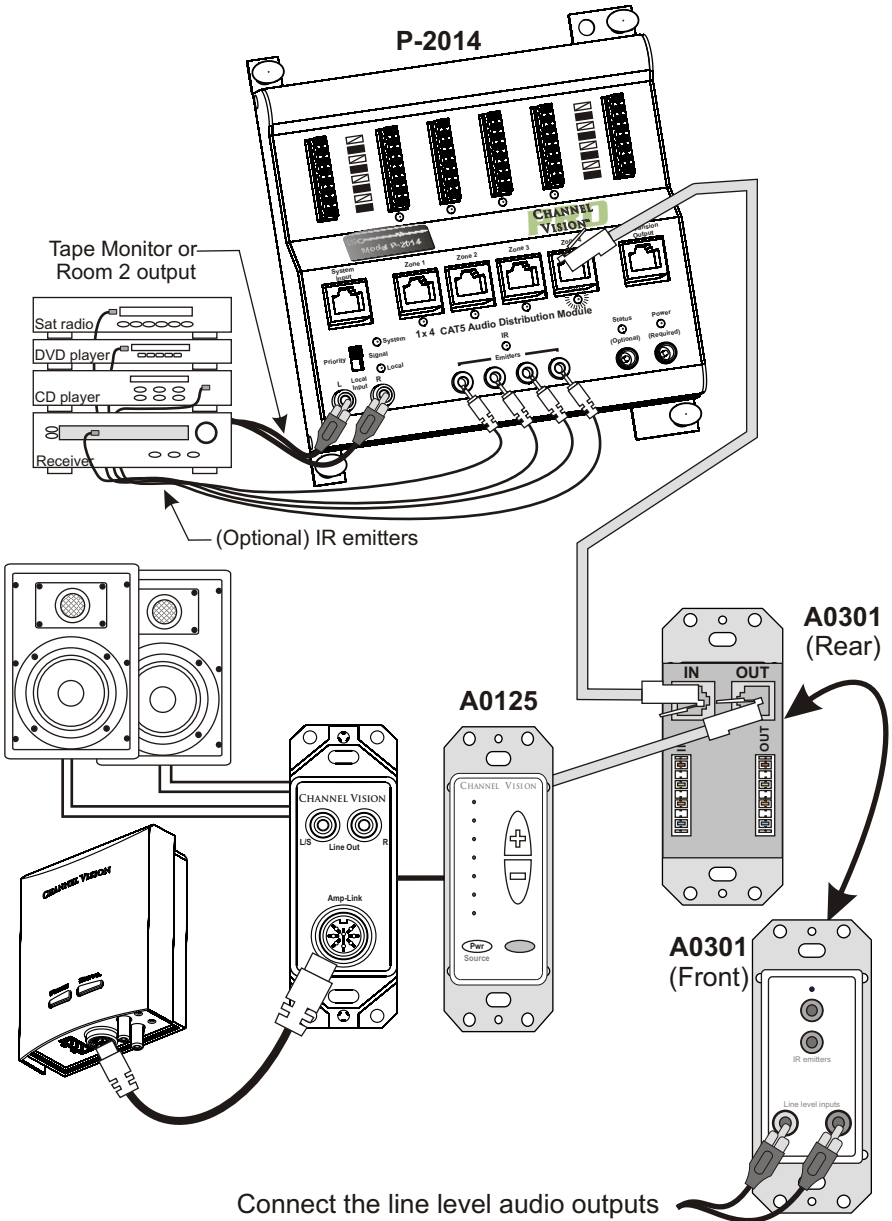

Connect the line level audio outputs of a local audio source, such as a TV, MP3 player, or computer.

Advanced System

Using the A0301 as the main source input module

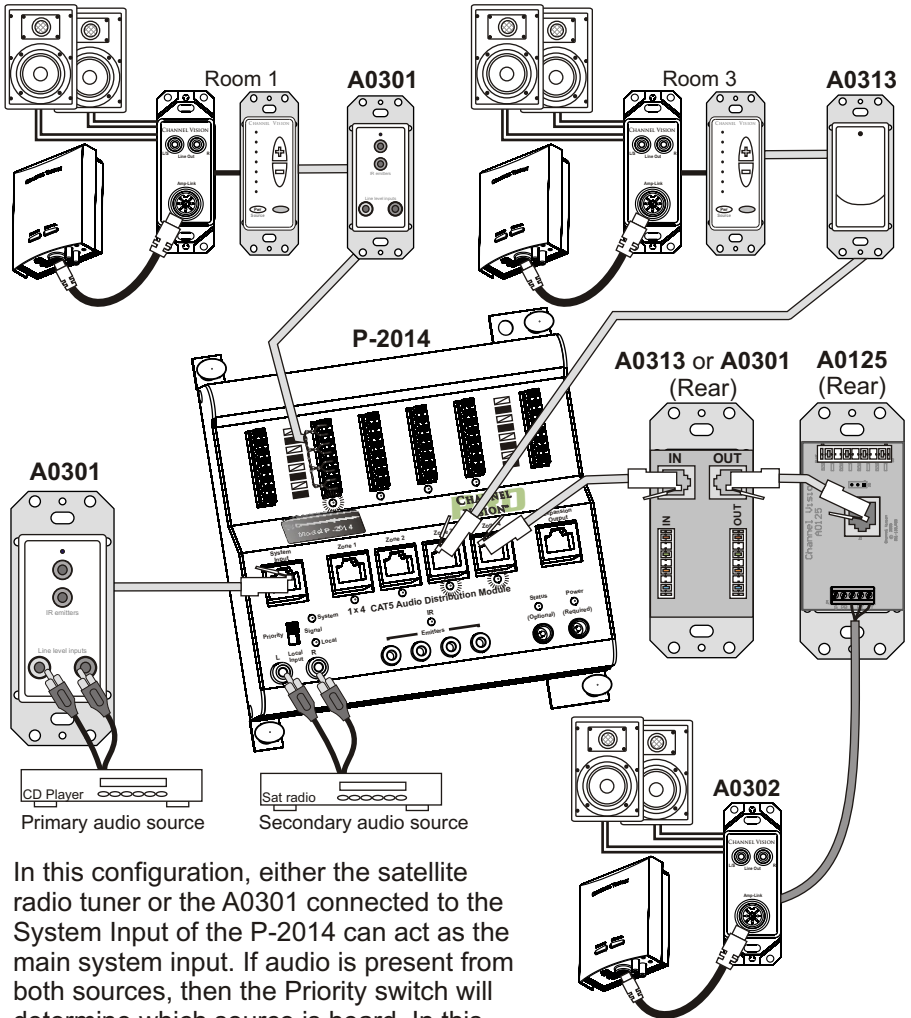

(See A0125 manual for connection details)

In this configuration, either the satellite radio tuner or the A0301 connected to the System Input of the P-2014 can act as the main system input. If audio is present from both sources, then the Priority switch will determine which source is heard. In this example the switch is set to give the A0301 priority.

A0301 and A0313 can be used as primary system inputs feeding the main hub or as local input modules in each room to override the primary audio source. The A0301 is a generic input module which provides a standard L/R RCA input and the A0313 is an iPod® docking station.

These local input modules should be installed in the CAT5 line between the P-2014 and the A0125. Multiple input modules can be installed in one CAT5 run. If audio is present at more than one input module the unit closest to A0125 will take priority and be played through the speakers.

Using IR Repeating

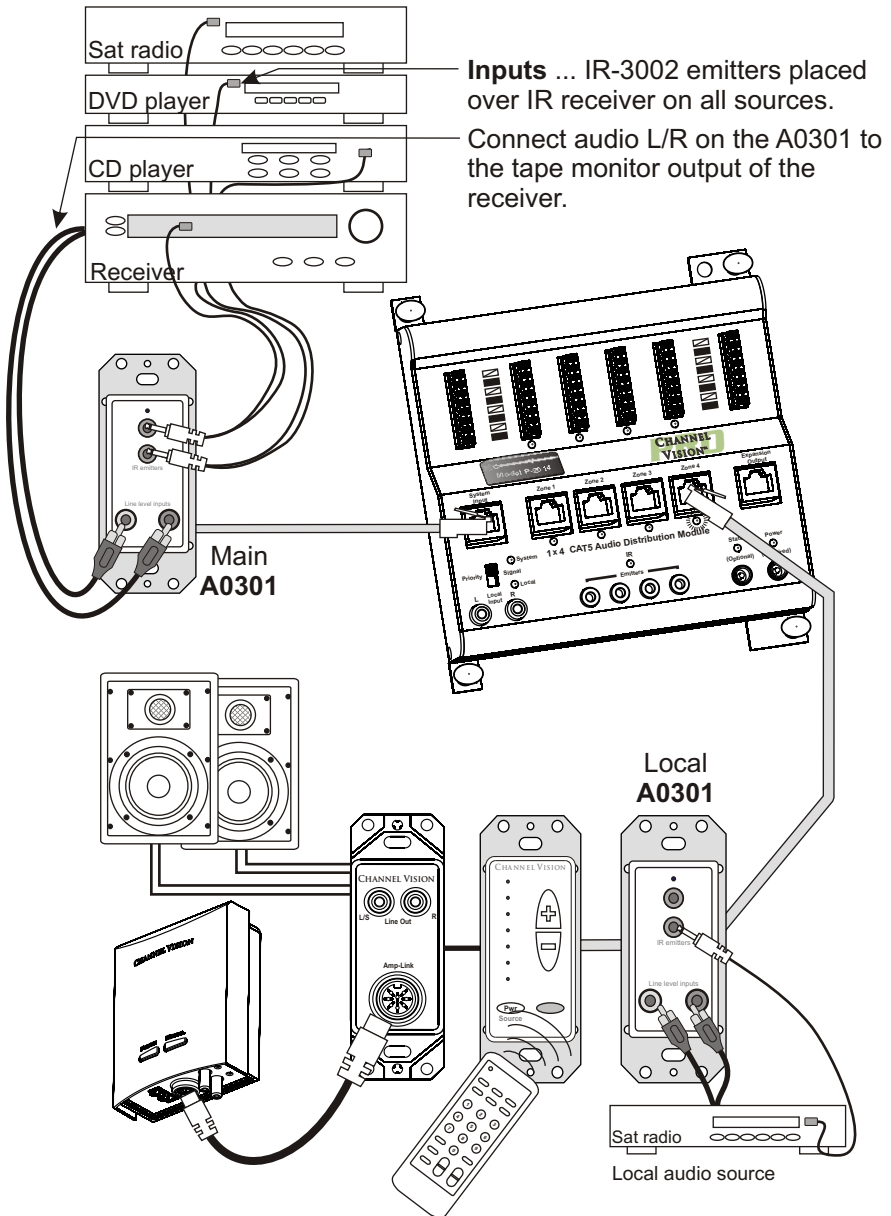

IR signals detected by the A0125 will be repeated at the local A0301 as well as the main A0301, making it easy to control either main source components or local source devices.

Stripping and Connecting CAT5 Wire

CAT5 cable should be stripped with a proper stripping tool, such as Channel Vision's J-110 tool.

1. Place the CAT5 between the blade and the first notch of the J-110 tool.

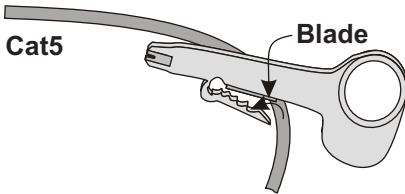

2. Rotate the tool only once around the CAT5. Multiple turns will cause you to cut into the inner wires.

3. Inspect the inner wires for damage. If any wires are cut start over at step 1.

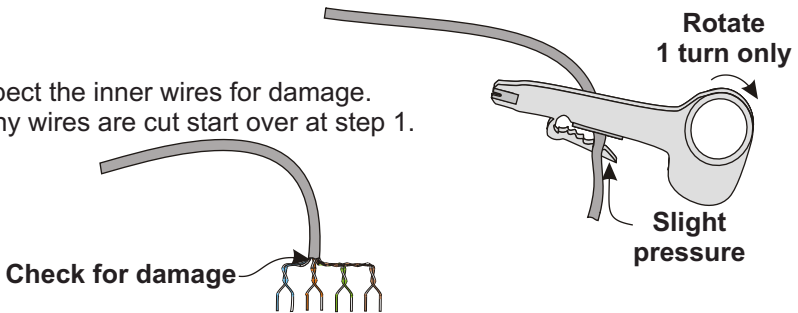

4. Use any standard 110 punch-down tool to properly seat all wires. Note: Do NOT use a screwdriver or any other tool that is not specifically designed for terminating UTP cable. Using improper tools will damage the connector!

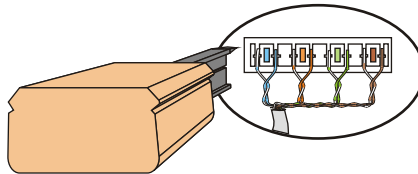

Specifications: (typical @25° C)

Operating Voltage : 18VDC

Cable requirements: CAT5 or better

Operating Temperature: -10°C to +50°C

Specifications subject to change without notice.

Apple and iPod is are trademarks of Apple, Inc., registered in the U.S. and other countries.

iBus is a registered trademark of Channel Vision Technology.

CHANNEL VISION™

2 Year Limited Warranty

Channel Vision Technology will repair or replace any defect in material or workmanship which occurs during normal use of this product with new or rebuilt parts, free of charge in the USA, for two years from the date of original purchase. This is a no hassle warranty with no mail in warranty card needed. This warranty does not cover damages in shipment, failures caused by other products not supplied by Channel Vision Technology, or failures due to accident, misuse, abuse, or alteration of the equipment. This warranty is extended only to the original purchaser, and a purchase receipt, invoice, or other proof of original purchase date will be required before warranty repairs are provided.

Mail in service can be obtained during the warranty period by calling (800) 840-0288 toll free. A Return Authorization number must be obtained in advance and can be marked on the outside of the shipping carton.

This warranty gives you specific legal rights and you may have other rights (which vary from state to state). If a problem with this product develops during or after the warranty period, please contact Channel Vision Technology, your dealer or any factory-authorized service center.

 CHANNEL VISION™
www.channelvision.com

234 Fischer Avenue, Costa Mesa, California 92626 USA
(714)424-6500 • (800)840-0288 • (714)424-6510 fax
email: techsupport@channelvision.com